



Laleham Close, St. Leonards-On-Sea TN37 7JH

Offers in excess of £350,000



3



1



1



D

A bright and spacious three bedroom END OF TERRACE HOUSE with OFF ROAD PARKING enviably placed within easy reach of local schools, good transport links, a range of shops and the Conquest Hospital, making this perfectly placed for family life. Occupying the corner plot of this QUIET CUL-DE-SAC, the accommodation here is arranged as a well presented living room positioned at the front of the property and leads through to the OPEN PLAN KITCHEN AND DINING ROOM which spans the rear of the property enjoying access to the garden. The kitchen is fitted with modern units housing ample storage and worktop space along with a separate island overlooking the dining area to create the ideal sociable setting. There is also an additional study on this floor. The first floor houses three bedrooms, two of which are GENEROUS DOUBLE ROOMS together with a STYLISH SHOWER ROOM. The rear garden is a particular feature here, relishing a secluded leafy surround, it offers multiple seating areas along with a section of patio off of the dining room while to the front of the property there is a DRIVEWAY providing off road parking for multiple vehicles leading to the garage which has been converted to offer three separate storage areas with space for utilities.

GROUND FLOOR  
623 sq.ft. (57.9 sq.m.) approx.

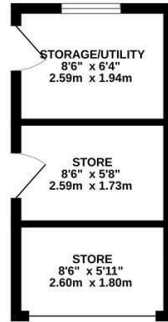

1ST FLOOR  
352 sq.ft. (32.7 sq.m.) approx.

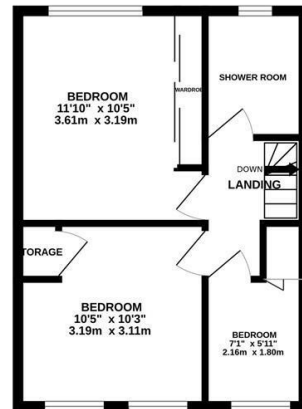

TOTAL FLOOR AREA : 975 sq.ft. (90.6 sq.m.) approx.

Whilst every attempt has been made to ensure the accuracy of the floorplan contained here, measurements of doors, windows, rooms and any other items are approximate and no responsibility is taken for any error, omission or mis-statement. This plan is for illustrative purposes only and should be used as such by any prospective purchaser. The services, systems and appliances shown have not been tested and no guarantee as to their operability or efficiency can be given.

Made with Metropix ©2025

